

- GENERAL NOTES:**
- All work indicated on these plans shall be done in conformity with applicable provisions of Standard Specifications No. 200 & Standard Drawings No. 2321 on file in the Office of the City Engineer.
 - Recess Curb for drainage where necessary shall be provided & width to be determined in the Plans.
 - Obstructions (Marking on plan) as directed by Engineer:
 - To be removed under this contract.
 - To be removed & substituted under this contract. Existing "B" Street Signs shall be Class "B" or better same as original.
 - To be removed or replaced by others.
 - To be removed & deposited on adjacent property.
 - To be removed or demolished under this contract.
 - Payment for all removal, overhaul and setting shall be included in prices paid for other contract items of work and no additional compensation will be allowed therefor.

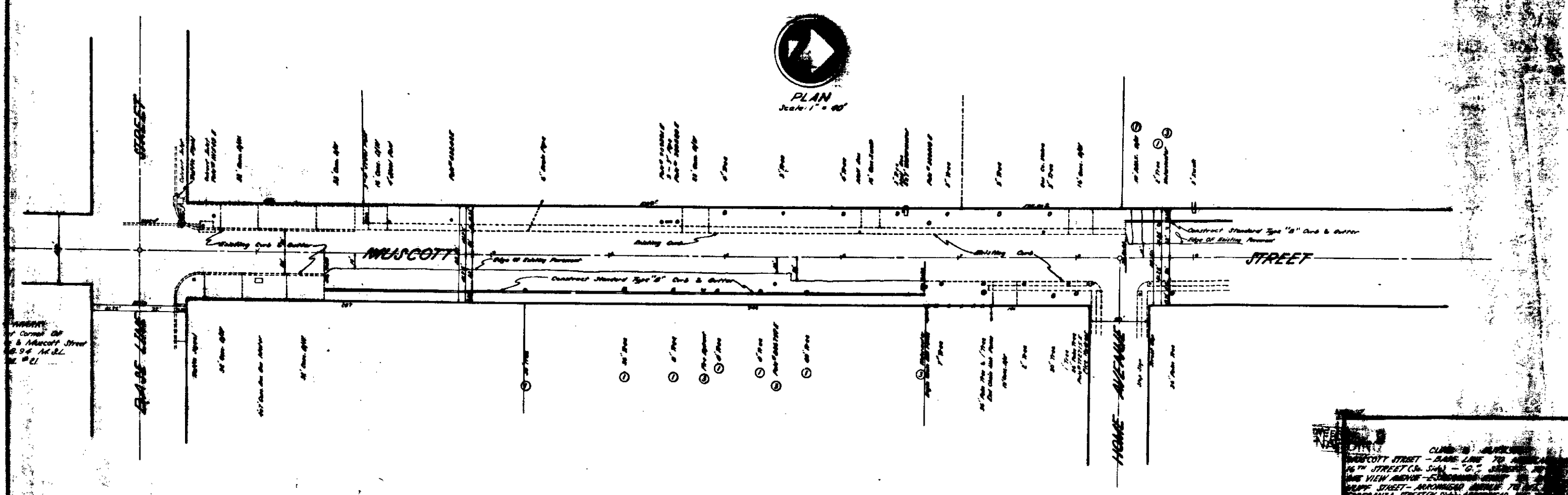

CLASIFIED
 MUSCOTT STREET - BASE LINE TO HOME AVENUE
 16TH STREET (S. S. 1/4) - "G" STREET TO HOME VIEW AVENUE - EXISTING CURB & GUTTER
 HOME VIEW AVENUE - EXISTING CURB & GUTTER TO MUSCOTT STREET - ARCHWAY UNDER TO MUSCOTT STREET (S. S. 1/4) - ARCHWAY UNDER TO MUSCOTT STREET (S. S. 1/4) - ARCHWAY UNDER TO MUSCOTT STREET (S. S. 1/4)

January 6, 1914
 Charles C. Wright